



Dashboard20-87

Instrument Panel Removal/Installation

NOTE:

- When prying with a flat-tip screwdriver, wrap it with protective tape, and apply protective tape around the related parts to prevent damage.
 - Take care not to scratch the dashboard and related parts.
 - LHD is shown, RHD is symmetrical.
1. Remove the driver's dashboard lower cover ([see page 20-88](#)).
 2. Remove the steering column upper cover ([see page 17-24](#)).
 3. Gently pull out the instrument panel (A) along the bottom to release the clips.

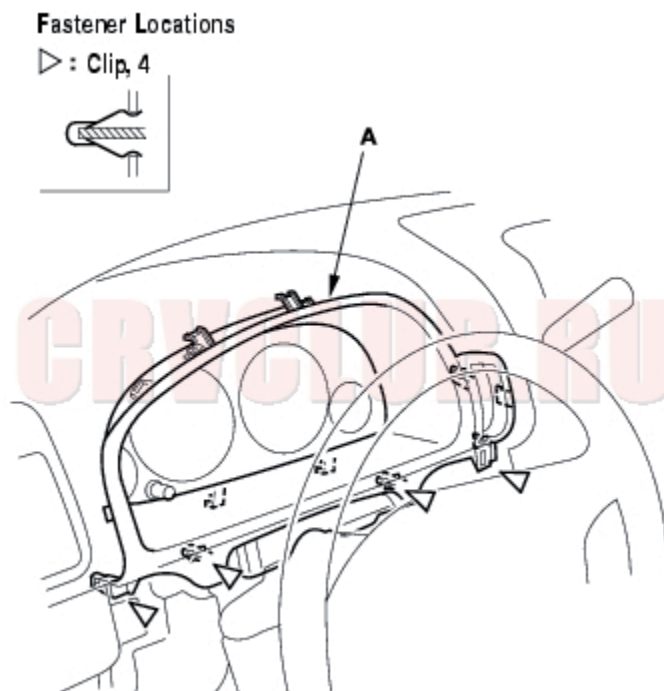

4. Remove the instrument panel (A).
5. Gently pull out the upper portion of the instrument panel to release the clips (B, C) and hooks (D, E, F, G).
6. Gently pull out on the panel being careful not bend the trip/reset (H) and dash lights brightness controller (for some models).

7. On A/T model, slip the shift knob (I) through the hole in the instrument panel.

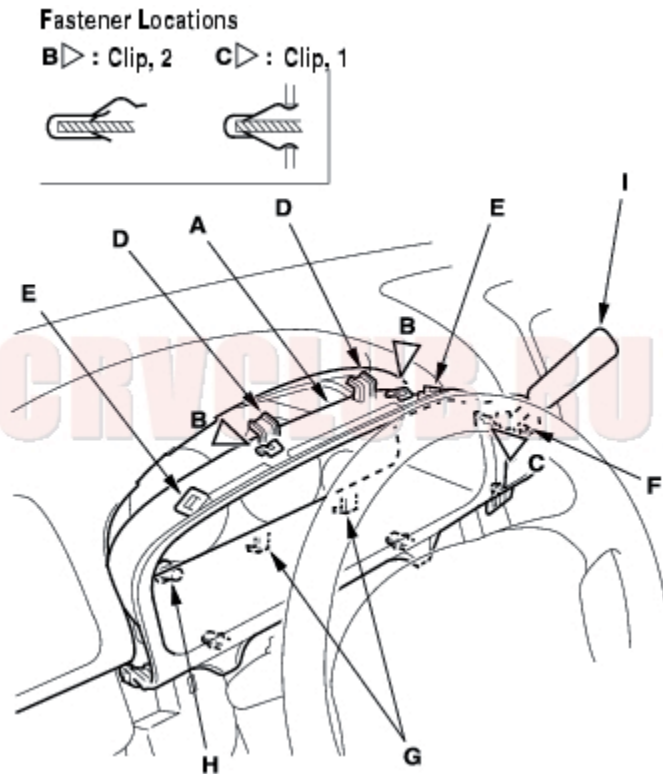

5. Install the panel in the reverse order of removal.

Driver's Dashboard Lower Cover Removal/Installation 20-88

NOTE:

- Take care not to scratch the dashboard and related parts.
 - LHD is shown, RHD is symmetrical.
1. Remove the screws (A) from the driver's dashboard lower cover (B).
 2. Pull out the bottom of the fuse lid (C) to release the clips (D), and pull it down to release the hooks (E).
 3. Remove the screw from the fuse lid opening.